

TECHNICAL BULLETIN #58

DATE: August 8, 2021

SUBJECT: Aqualung regulator service kit information cards with incorrect o-ring part numbers



Dear Aqualung Group Partner,

The service kit information card in our current revision of regulator service kits have o-ring part numbers on the card that are incorrect and do not match the part numbers on the schematics in the Spare Parts Guide or the Technical Maintenance Manuals. We are in the process of getting new cards which will be used in the next round of service kits manufactured. To assist you with servicing your regulators, we are providing a copy of the revised card with the correct o-ring part numbers shown in red. This card's part numbers match the numbers in the schematics. The pictures of the o-rings have not been affected by this and are the correct size.

PRODUCTS AFFECTED: The following service kits,
RA121124 / RA121125 / RA121126 / RA121127 / RA121128

**Should you have any questions regarding this issue,
please contact our customer service department at:
(877) 253-DIVE**

AQUALUNG GROUP
TEL +1 760 597 5000
2340 Cousteau Court, Vista, CA 92081

TECHNICAL BULLETIN

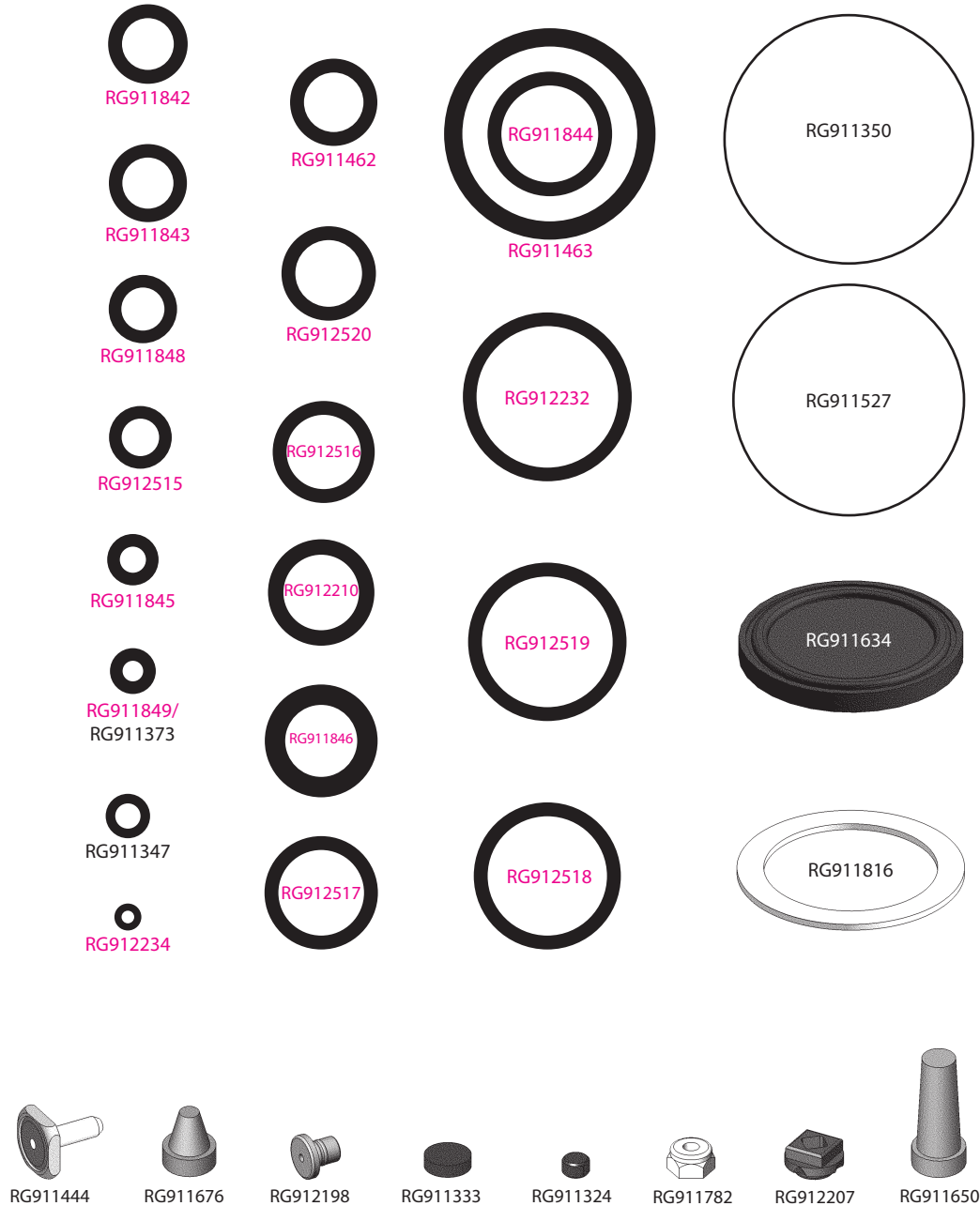

THESE PARTS ARE NITROX COMPATIBLE WITH BLENDS UP TO 40% OXYGEN ONLY IF THEY ARE PROPERLY LUBRICATED AND INSTALLED INTO A PROPERLY CLEANED REGULATOR. FOR USE BEYOND 40% OXYGEN, ESTABLISHED OXYGEN CLEANING PROCEDURES MUST BE USED.

TECHNICAL BULLETIN

RA121124	Service kit piston 1 st stage	Calypso	
		<2010	≥2010
RG911324	HP seat	1	1
RG911462	O-ring	1	1
RG911842	O-ring	4	4
RG911845	O-ring	2	1
RG911463	O-ring	1	1
RG911846	O-ring	DIN	DIN
RG911650	Filter non-ACD	1	1
RG911844	O-ring	1	

STD: Regulator for water over 10°C.

SUP: Regulator for water below or equal 10°C.

RA121125	Service kit 1 st stage balanced diaphragm	Titan ≥ 2010/Mikron < 2017		Titan LX ≥ 2010				Core/Mikron ACD	
		STD	SUP	Non ACD		ACD		STD	SUP
				STD	SUP	STD	SUP		
RG911444	HP seat	1	1	1	1	1	1	1	1
RG911843	O-ring	1	1	1	1	1	1	1	1
RG911527	Diaphragm secondary		1		1		1		1
RG911848	O-ring					DIN	DIN	DIN	DIN
RG912520	O-ring					DIN	DIN	DIN	DIN
RG911846	O-ring	DIN	DIN	DIN	DIN	DIN	DIN	DIN	DIN
RG911676	Filter ACD					1	1	1	1
RG912515	O-ring					YOKE	YOKE	YOKE	YOKE
RG911350	Diaphragm	1	1	1	1	1	1	1	1
RG911347	Backup ring	1	1	1	1	1	1	1	1
RG911523	Washer	1	1	1	1	1	1	1	1
RG911849	O-ring	1	1	1	1	1	1	1	1
RG912210	O-ring	1	1	1	1	1	1	1	1
RG911462	O-ring	2	2	2	2	2	2	2	2
RG911842	O-ring	4	4	4	4	5 YOKE / 4 DIN		5 YOKE / 4 DIN	
RG911650	Filter non ACD	1	1	1	1				

RA121126	Service kit 1 st stage over balanced diaphragm	Legend			Glacia/Leg3nd	
		Non ACD < 2006	ACD		<2014	≥2014
			<2012	≥2012		
RG911444	HP seat	1	1	1	1	1
RG911843	O-ring	1	1	1	1	1
RG911347	Backup ring	1	1	1	1	1
RG911849	O-ring	1	1	1	1	1
RG911462	O-ring	2	2	2	2	2
RG911842	O-ring	5	5 YOKE / 4 DIN		5 YOKE / 4 DIN	
RG911846	O-ring	DIN	DIN	DIN	DIN	DIN
RG911650	Filter non-ACD	1				
RG911350	Diaphragm	1	1	1	1	1
RG911816	Thrustwasher	1	1		1	
RG912210	O-ring	1	1	1	1	1
RG911634	Diaphragm secondary	1	1	1	1	1
RG911676	Filter ACD		1	1	1	1
RG911848	O-ring		DIN	DIN	DIN	DIN
RG912520	O-ring		DIN	DIN	DIN	DIN
RG912515	O-ring		YOKE	YOKE	YOKE	YOKE

RA121127	Service kit 2 nd stage non-balanced	Calypso / Titan	
		Classic	QC
RG911842	O-ring	1	1
RG912518	O-ring		2
RG911848	O-ring	2	2
RG911782	Locknut	1	1
RG911333	MP seat	1	1
RG911844	O-ring	2	
RG912207	Poppet Bearing	1	

RA121128	Service kit 2 nd stage balanced	Mikron	Titan LX	Core	Legend/Leg3nd			Glacia/Leg3nd Elite		
					NON LX/Leg3nd/ OCTOPUS	LX/LUX/Leg3nd MBS		OCTO-PUS	< 2012	≥ 2012
						< 2012	≥ 2012			
RG912515	O-ring					1				1
RG912198	MP seat	1	1	1	1	1	1	1	1	1
RG911848	O-ring	2	2	2	2	2	2	2	2	2
RG912232	O-ring		1	1	1	1	1	1	1	1
RG911844	O-ring	1	2	2	2	2	1	2	2	2
RG912234	O-ring	1	1	1	1	1	1	1	1	1
RG911842	O-ring	1	2	2	2	2	1	2	2	2
RG912516	O-ring	1								
RG912519	O-ring	1								
RG911845	O-ring	1								
RG911373	O-ring						1			
RG912517	O-ring						1			