

109 ADJUSTABLE 2ND STAGE

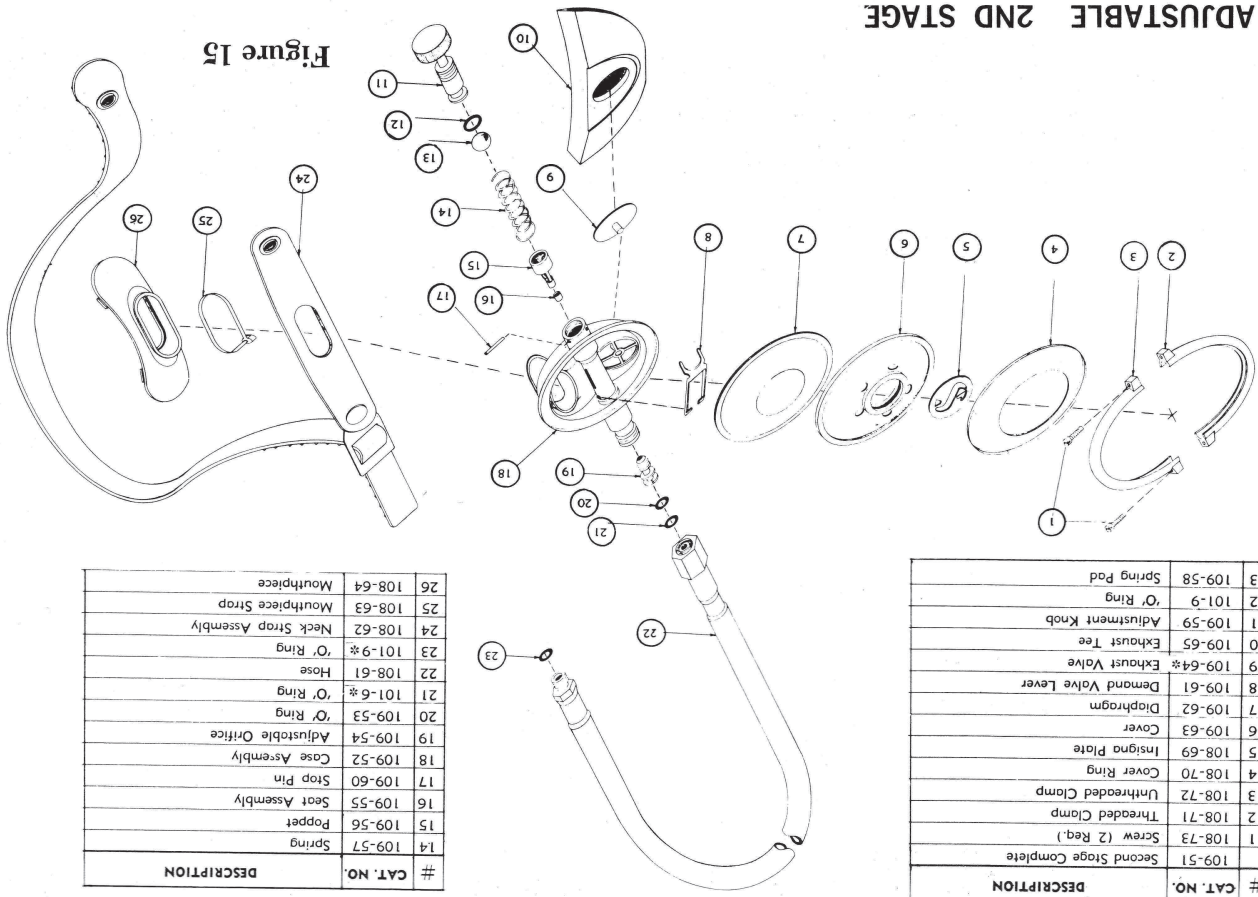

#	CAT. NO.	DESCRIPTION
1	109-51	Second Stage Complete
2	108-71	Threaded Clamp
3	108-72	Unthreaded Clamp
4	108-70	Cover Ring
5	108-69	Insigna Plate
6	109-63	Cover
7	109-62	Diaphragm
8	109-61	Demand Valve Lever
9	109-64*	Exhaust Valve
10	109-65	Exhaust Tee
11	109-59	Adjustment Knob
12	101-9	'O' Ring
13	109-58	Spring Pad

#	CAT. NO.	DESCRIPTION
14	109-57	Spring
15	109-56	Poppet
16	109-55	Seat Assembly
17	109-60	Stop Pin
18	109-52	Case Assembly
19	109-54	Adjustable Orifice
20	109-53	'O' Ring
21	101-61*	'O' Ring
22	108-61	Hose
23	101-9*	'O' Ring
24	108-62	Neck Strap Assembly
25	108-63	Mouthpiece Strap
26	108-64	Mouthpiece

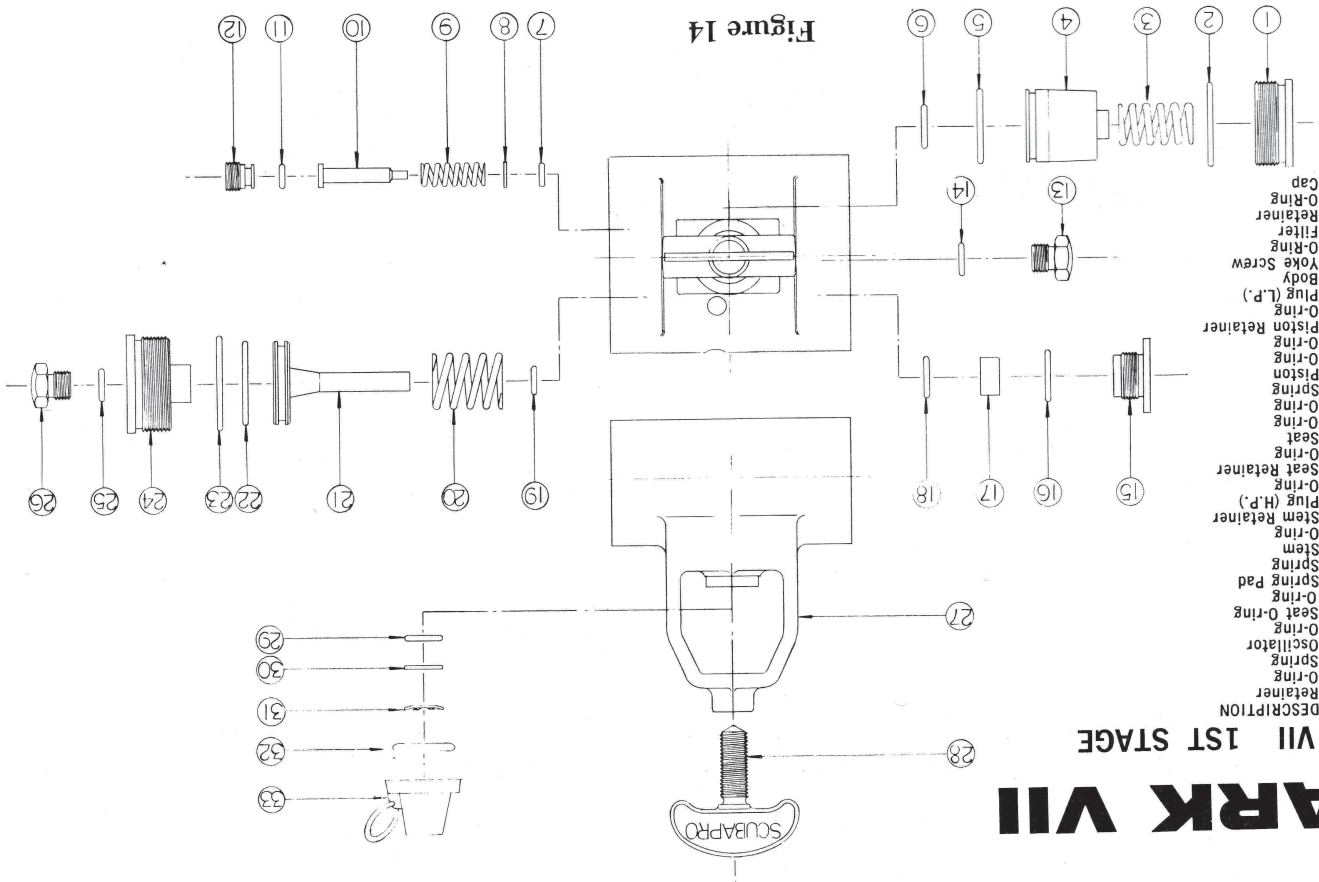

NO.	CAT. NO.	DESCRIPTION
1	107-5	Retainer
2	101-3	O-Ring
3	107-7	O-Ring
4	107-8	Oscillator
5	107-9*	O-Ring
6	107-10*	Seat O-Ring
7	102-5	O-Ring
8	107-12	Spring Pad
9	107-11	Spring
10	107-13	Stem
11	102-5	O-Ring
12	107-14	Stem Retainer
13	101-8	Plug (H.P.)
14	101-9	Seat Retainer
15	101-13	O-Ring
16	101-12*	Seat
17	101-11*	O-Ring
18	101-10*	O-Ring
19	101-6	Spring
20	101-5	Spring
22	101-3*	Piston
23	107-3	O-Ring
24	107-4	Piston Retainer
25	101-9	Plug (L.P.)
26	101-8	O-Ring
27	107-2	Body
28	101-20	Yoke Screw
29	101-17*	O-Ring
30	101-18*	Filter
31	101-19*	Retainer
32	101-22*	O-Ring
33	101-21	Cap

# MARK VII