



# SCUBAPRO

3105 E. Harcourt St./Compton, Calif. 90221

106-1

MK 6 FIRST STAGE

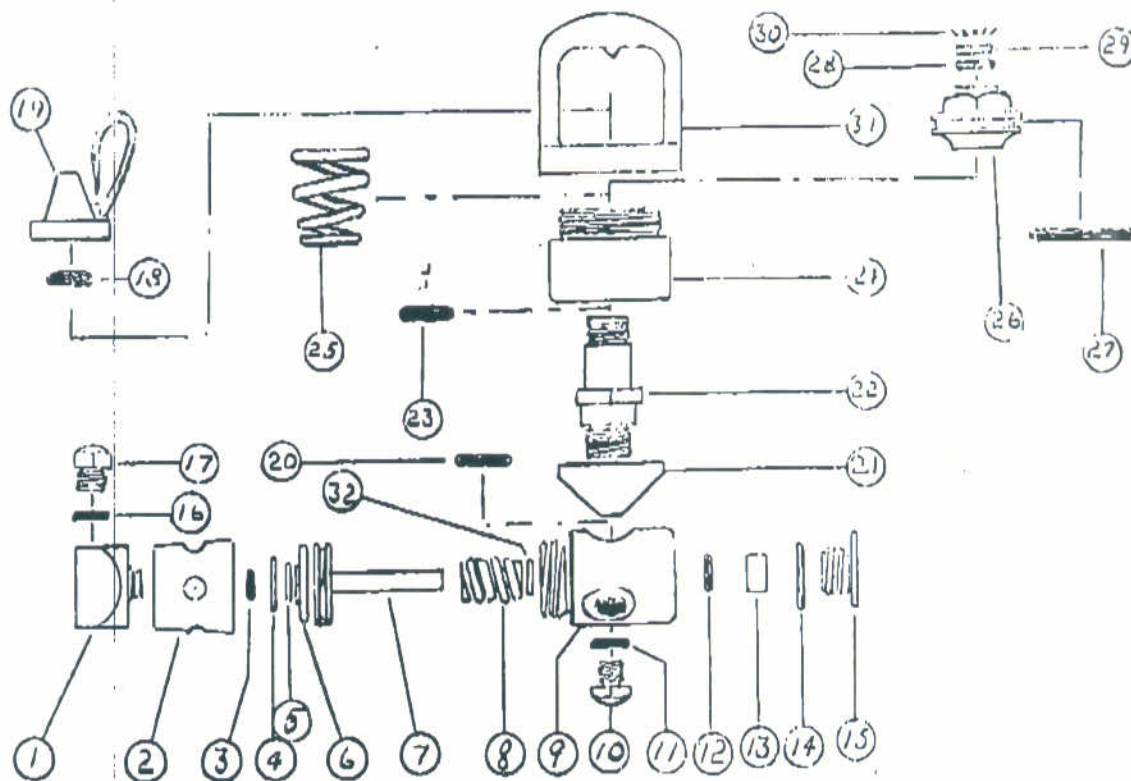

| #  | CAT. NO.   | DESCRIPTION     | PRICE | #  | CAT. NO.   | DESCRIPTION          | PRICE |
|----|------------|-----------------|-------|----|------------|----------------------|-------|
| 1  | 10.105.113 | SWIVEL          |       | 18 | 01-050-196 | O' RING              |       |
| 2  | 10.105.114 | CAP             |       | 19 | 10.101.211 | PROTECTION CAP ASSY. |       |
| 3  | 01-050.144 | O' RING         |       | 20 | 01-050-380 | O' RING              |       |
| 4  | 01-060.105 | WASHER          |       | 21 | 10.101.050 | SADDLE               |       |
| 5  | 01.105.102 | SWIVEL RETAINER |       | 22 | NLA        | PISTON RETAINER      |       |
| 6  | 01-050.179 | O' RING         |       | 23 | 01-050.380 | O' RING              |       |
| 7  | 10.101.003 | PISTON          |       | 24 | NLA        | HOUSING              |       |
| 8  | 01.020.101 | SPRING          |       | 25 | NLA        | SPRING               |       |
| 9  | 10.101.141 | BODY            |       | 26 | NLA        | PISTON               |       |
| 10 | 10.101.139 | PLUG            |       | 27 | 01-050.179 | O' RING              |       |
| 11 | 01-050.137 | O' RING         |       | 28 | 01-050.144 | O' RING              |       |
| 12 | 01-050.147 | O' RING         |       | 29 | 01-028.101 | FILTER               |       |
| 13 | 10.101.151 | SEAT            |       | 30 | 01-073.101 | FILTER RETAINER      |       |
| 14 | 01-050.157 | O' RING         |       | 31 | NLA        | YOKE                 |       |
| 15 | 10.101.106 | SEAT RETAINER   |       | 32 | 01-050.137 | O' RING              |       |
| 16 | 01-050.132 | O' RING         |       | 33 |            | NYLON LOCKING PLUG   |       |
| 17 | 10.101.104 | PLUG            |       |    |            |                      |       |

Prices subject to change without notice.