

# SCUBAPRO

Technical Service Schematic

**MK 15 FIRST STAGE #10-600-000**

Date 12/97      Revision B  
Annual Repair Parts Kit #10-600-041

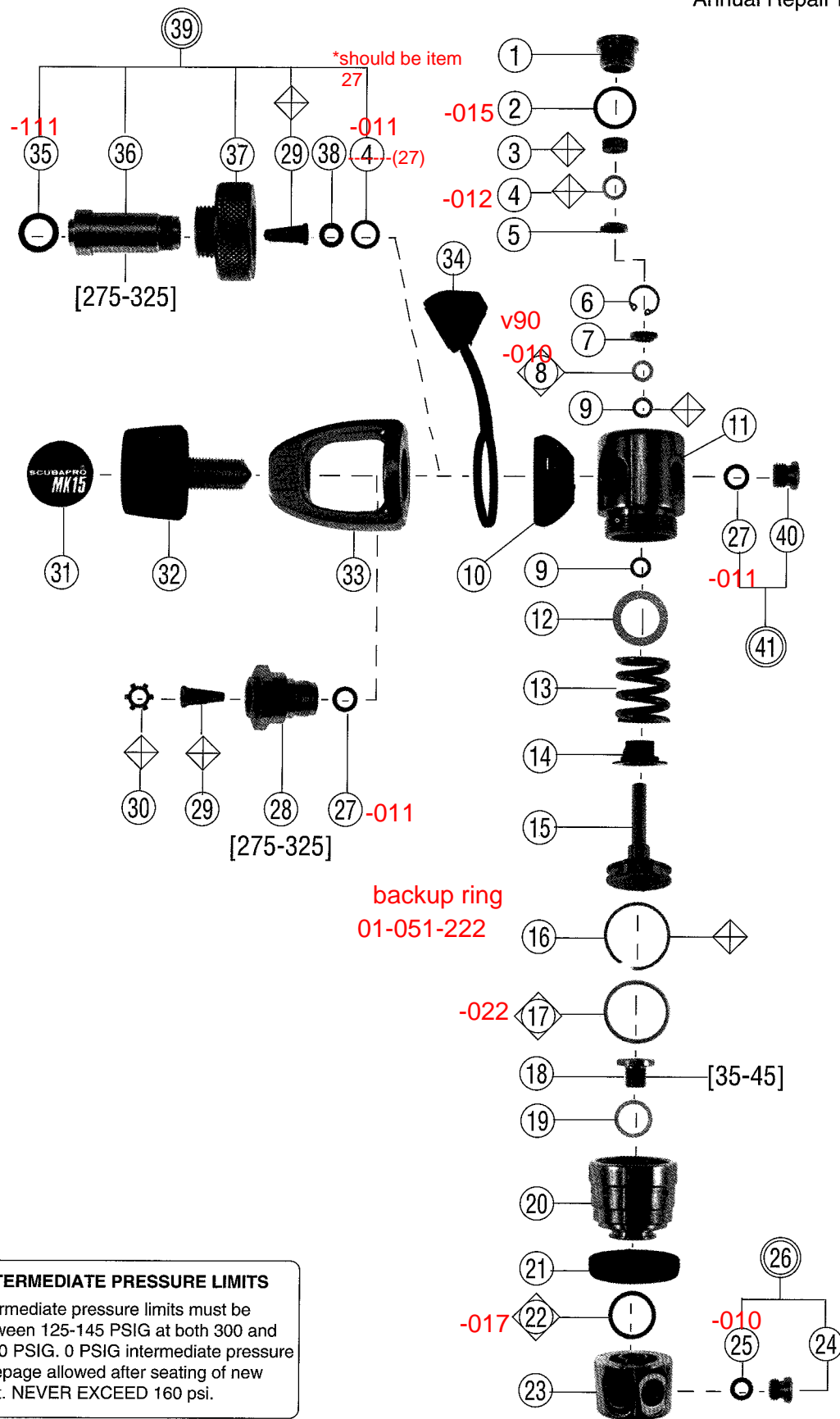

## INTERMEDIATE PRESSURE LIMITS

Intermediate pressure limits must be between 125-145 PSIG at both 300 and 3000 PSIG. 0 PSIG intermediate pressure creepage allowed after seating of new seat. NEVER EXCEED 160 psi.

# SCUBAPRO

Technical Service Schematic

**MK 15 FIRST STAGE 10-600-000**

Date 12/97      Revision B  
Annual Repair Parts Kit #10-600-041

## Parts

#	QTY	PART #	DESCRIPTION	COST
* 1	1	10-600-125	RETAINER, SEAT, HP	
2	1	01-050-398	O-RING, SEAT RETAINER, BLACK	
* 3	1	10-600-123	SEAT, HP	
* 4	1	01-050-401*	O-RING, SEAT, AMBER (no SP record of a -401)	
5	1	10-600-124	INSERT BUSHING, CHROME (Prob. a -425 PU 85 -012)	
6	1	01-073-112	RETAINING RING, O-RING, COPPER	
7	1	10-600-129	WASHER, RING, RETAINING	
8	1	01-050-137	O-RING, PISTON, SHAFT, AMBER	
* 9	2	01-060-600	WASHER, O-RING	
10	1	10-600-111	SADDLE, MK15	
11	1	10-600-101	BODY, MK15	
* 12	1	01-060-218	WASHER, SHIM, MK15	
13	1	01-020-600	SPRING, MK15	
14	1	10-600-115	SLEEVE, PLASTIC, MK15	
15	1	10-600-103	PISTON, MK15	
16	1	01-051-222	RING, BACK-UP	
17	1	01-050-179	O-RING, PISTON, LARGE, AMBER	
18	1	10-500-103	RETAINER, SWIVEL	
19	1	01-060-500	WASHER, SWIVEL	
20	1	10-600-102	CAP, SWIVEL, MK15	
21	1	10-600-114	TRIM BUMPER, SWIVEL, MK15	
22	1	01-050-161	O-RING, SWIVEL	
23	1	10-600-118	SWIVEL, MK 15	
24	4	10-101-104	PLUG, LP, (3/8-24)	
25	4	01-050-132	O-RING, LP PLUG, BLUE	
26	4	10-101-006	PLUG, LP, (3/8-24) WITH O-RING	
27	1	01-050-138	O-RING, HP PLUG & YOKE RTNR, BLUE	
28	1	10-600-104	RETAINER, YOKE, MK15	
29	1	01-028-109	FILTER	
30	1	01-073-101	RETAINER	
31	1	01-006-623	DECAL, YOKE SCREW, MK15	
32	1	10-200-008	YOKE SCREW ASSEMBLY	
33	1	10-101-157	YOKE, MACHINED, SATIN FINISH	
34	1	10-101-211	HP, PROTECTOR, COMBO YOKE/DIN	
35	1	01-050-193	O-RING, DIN, BLACK	
36	1	10-400-107	RETAINER, DIN, 300 BAR	
37	1	10-105-118	KNOB, DIN, 300 BAR	
38	1	01-060-501	WASHER, DIN	
○ 39	1	10-400-030	KIT, DIN, 300 BAR	
40	1	10-101-139	PLUG, HP, (7/16-20)	
41	1	10-101-039	HP PLUG WITH O-RING (7/16-20)	
○ ● 1	1	10-600-119	SPEC BOOT, MK15	
○ ● 1	1	10-600-020	SPEC KIT, W/BOOT & SILICONE GREASE	
* ● 1	1	10-600-051	MK15 UPGRADE KIT	

## Technical Information:

### ALLEN WRENCH SIZES:

#28 yoke retainer 5/16 or 8mm

#24 LP Plug 5/32

#40 HP Plug 5/32

#36 Din retainer 15/32 or 6mm

Item #13 note: 01-020-601 spring (red) may be used if lower intermediate pressures are required.

## Special Engineering Notes:

Flow through piston designs will under some conditions make a whistling noise during flow. To alleviate, heavily lubricate Item #8, 01-050-137 and/or replace item #3, 10-600-123 HP seat.

Reference Item #1 If MK15 HP seat retainer has the Allen Hex 8mm inset, install Upgrade Kit #10-600-051. (See Engineering Bulletins #234).

Reference Item #12: A maximum of 3 washers (#10-060-218) may be used to adjust intermediate pressure to specified limits.

## Legend (prices subject to change without notice)

● Not Shown      ◇ Dynamic O'Ring Replace Annually

○ Optional Item      ◇ Annual Replacement

▲ Limited Warranty      [   ] Torque In Inch Pounds

□ Older Configuration      \* See Note