

Mikron 2008-Present

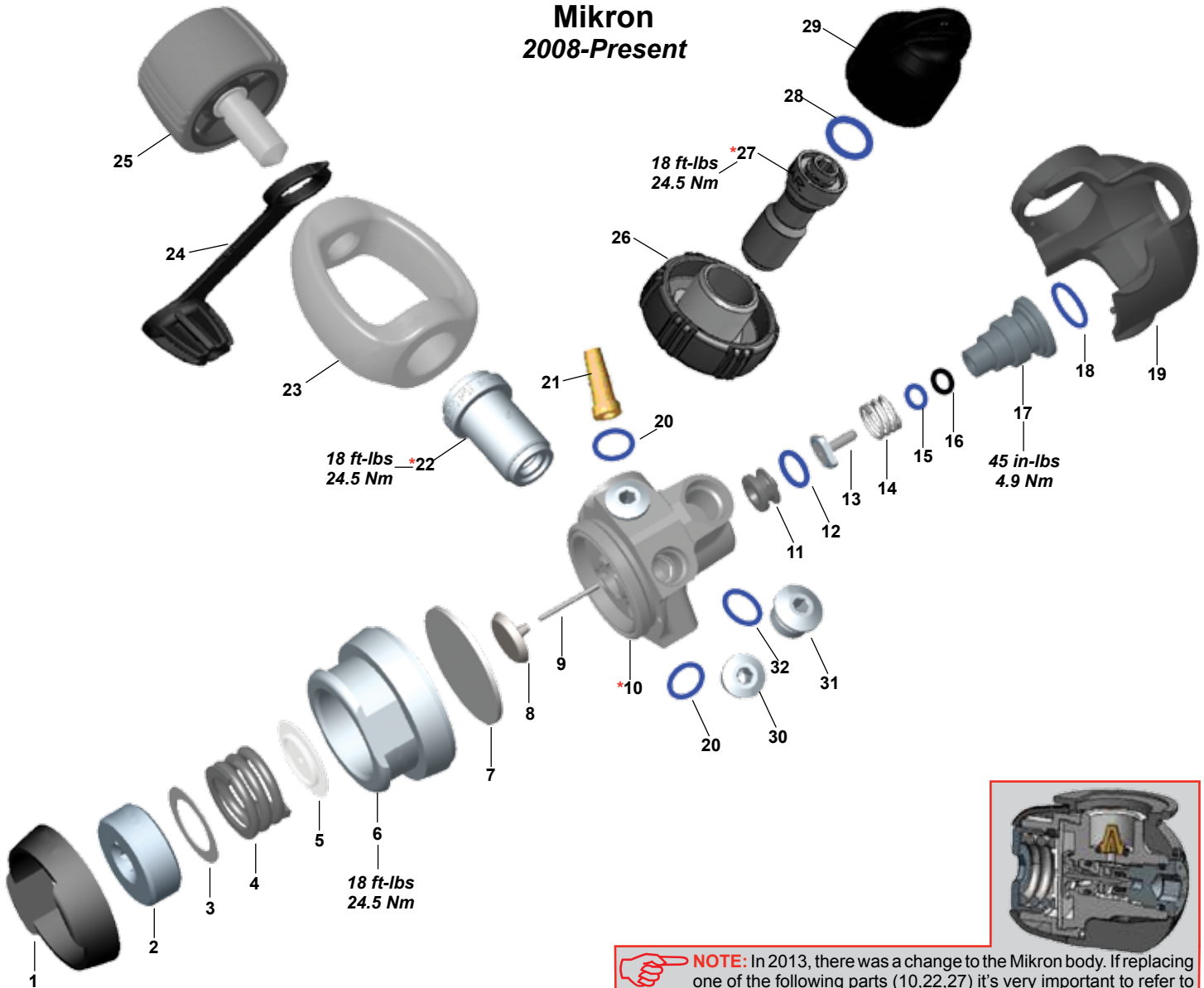

NOTE: In 2013, there was a change to the Mikron body. If replacing one of the following parts (10,22,27) it's very important to refer to Technical Bulletin #38 Jan 1, 2013 for more information.

Key #	Part #	Description
----	900014	Overhaul Parts Kit, (Yoke and DIN)
----	127945	First Stage, Mikron, Yoke, Blk/Blue
----	127925	First Stage, Mikron, Yoke, Blk/Pink
----	129022	DIN Adapter Kit (2013>)
----	127865	DIN Adapter Kit (<2012)
1----	127888	Spacer, Black/Blue
----	127878	Spacer, Black/Pink
----	127872	Spacer, Black/Green
----	127837	Spacer, Black/Red
----	127839	Spacer, Vanilla
2----	127566	Adjustment Screw
3----	127568	Washer
4----	127567	Spring
5----	127565	Spring Pad
6----	127583	Spring Retainer
----	127874	Spring Retainer, (2-HP Ports)
7----	119159	Diaphragm
8----	127563	Pin Support
9----	127564	Pin
10----	129254	Body, 2013
----	NLA	Pre 2013 Body, w/2-HP Ports
----	NLA	Pre 2013 Body, w/1-HP Port
11----	127585	Crown

Key #	Part #	Description
12----	820038P	O-ring (20 pk)
13----	105940	HP Seat
14----	122244	Spring
15----	820080P	O-ring (25 pk)
16----	119129	Back-up Ring
17----	129120	Plug
18----	824407P	O-ring (20 pk)
19----	127876	Sheath, Black, (2-HP Ports)
----	127831	Sheath, Vanilla, (1-HP Port)
----	127804	Sheath, Black, (1-HP Port)
20----	820011P	O-ring (25 pk)
21----	129151	Filter
22----	129253	Inlet Fitting, 2013
----	127808	Inlet Fitting
23----	127807	Yoke
24----	124555	Dust Cap
25----	127805	Yoke Screw
26----	127803	DIN Handwheel
27----	129251	DIN Fitting, 2013
----	127801	DIN Fitting
28----	820094P	O-ring (20 pk)
29----	124665	DIN ACD Cap
30----	103133	Plug, MP Port, 3/8"
31----	103137	Plug, HP Port, 7/16"
32----	820072P	O-ring (20 pk)

Part numbers in **BOLD ITALICS** indicate standard overhaul replacement part