

No	Réf	Qté	Désignation	Description
1	129809	1	corps HP satin Legend 2 marqué	Legend 2 satin first stage body marked
2	<b>124624</b>	<b>1</b>	<b>Clapet HP</b>	<b>HP seat</b>
3	127585	1	Siège	Crown
4	A02002	1	Aiguille	Pin
5	129121	1	Poussoir	Pin support
6	<b>119159</b>	<b>1</b>	<b>Diaphragme</b>	<b>Diaphragm</b>
7	129602	1	Ecrou chambre sèche Legend	Legend dry chamber screw
8	129606	1	Piston Legend	Legend Piston
9	127567	1	Ressort MP	IP spring
10	127565	1	Embase Ressort MP	Spring Pad
11	<b>129126</b>	<b>1</b>	<b>Membrane</b>	<b>Diaphragm</b>
12	127568	1	Rondelle	Washer
13	127566	1	Ecrou réglage MP	IP Adjusting screw
14	<b>129209</b>	<b>1</b>	<b>Filtre Legend ACD</b>	<b>ACD Legend filter</b>
15	129613	2	bouchon HP 7/16" Legend	Legend 7/16" HP plug
16	129612	3	Bouchon MP 3/8" Legend	Legend 3/8" IP plug
17	129744	1	Bouchon chambre sèche satin Legend 2	Legend 2 satin dry chamber plug
18	129608	1	Bouchon ACD DIN	Din ACD Cap
19	129611	1	Rondelle chambre sèche Legend	Legend dry chamber washer
20	129609	1	Protecteur chambre sèche Legend	Legend dry chamber protector
21	129617	1	Sticker Legend encollé	Legend Sticker (with pasting)
22	129746	1	Chambre compensation satin LEGEND 2	LEGEND 2 satin counter balance cylinder
23	129204	1	Ressort ACD	ACD spring
24	122244	1	Ressort	Spring
25	<b>124704</b>	<b>1</b>	<b>JT 1.9x7.2 EPDM 80ShA</b>	<b>OR 1.9x7.2 EPDM 80ShA</b>
26	<b>119129</b>	<b>1</b>	<b>Bague Anti Extrusion 1,35 x 3,56 NITRILE 90ShA</b>	<b>Anti Extrusion Washer 1,35 x 3,56 NITRILE 90ShA</b>
27	<b>124612</b>	<b>1</b>	<b>JT 1.78x2.9 EPDM 90ShA</b>	<b>OR 1.78x2.9 EPDM 90ShA</b>
28	<b>213714</b>	<b>1</b>	<b>JT 2x11 EPDM 80shA</b>	<b>OR 2x11 EPDM 80shA</b>
29	129214	1	Porte filtre Legend ACD	ACD Din filter holder
30	129619	1	Volant DIN souple ACD	Soft DIN handwheel
31	129213	1	vis DIN ACD Legend	DIN screw ACD Legend
32	129203	1	Siège d'Obturateur Din	Din shutter crown
33	129202	1	Nez Obturateur DIN	DIN Shutter Valve
34	<b>124703</b>	<b>4</b>	<b>Bague</b>	<b>O-ring</b>
35	<b>124709</b>	<b>1</b>	<b>JT 2.7 x 10.5 85ShA</b>	<b>OR 2.7 x 10.5 85ShA</b>
36	<b>444243</b>	<b>1</b>	<b>JT 1.78x6.07 EPDM 80ShA</b>	<b>OR 1.78x6.07 EPDM 80ShA</b>
37	<b>473057</b>	<b>1</b>	<b>bague</b>	<b>O-ring</b>
38	<b>124701</b>	<b>2</b>	<b>Joint torique 1.78x8.74</b>	<b>O-ring 1.78x8.74</b>
39	129747	1	Echangeur chambre sèche satin LEGEND 2	LEGEND 2 satin dry chamber Ring

(A)

			Désignation	Premier étage Legend 2 Suprême ACD DIN	Visa: TM
			Description	Legend 2 Supreme ACD DIN First Stage	1ère Avenue, 14ème rue - BP 148 06513 CARROS CEDEX FRANCE Tel: (33) 04 92 08 28 88 Fax: (33) 04 92 08 28 99
			Notice	- - - - -	<b>AQUALUNG</b>
			Date	29/06/11	VE 129735 A
2063	08/12/11	A			
N°	Date Modif	Ind			

No	Réf	Qté	Désignation	Description
1	129809	1	corps HP satin Legend 2 marqué	Legend 2 satin first stage body marked
<b>2</b>	<b>124624</b>	<b>1</b>	<b>Clapet HP</b>	<b>HP seat</b>
3	127585	1	Siège	Crown
4	A02002	1	Aiguille	Pin
5	129121	1	Poussoir	Pin support
<b>6</b>	<b>119159</b>	<b>1</b>	<b>Diaphragme</b>	<b>Diaphragm</b>
7	129602	1	Ecrou chambre sèche Legend	Legend dry chamber screw
8	129606	1	Piston Legend	Legend Piston
9	127567	1	Ressort MP	IP spring
10	127565	1	Embase Ressort MP	Spring Pad
<b>11</b>	<b>129126</b>	<b>1</b>	<b>Membrane</b>	<b>Diaphragm</b>
12	127568	1	Rondelle	Washer
13	127566	1	Ecrou réglage MP	IP Adjusting screw
<b>14</b>	<b>129209</b>	<b>1</b>	<b>Filtre Legend ACD</b>	<b>ACD Legend filter</b>
15	129613	2	bouchon HP 7/16" Legend	Legend 7/16" HP plug
16	129612	3	Bouchon MP 3/8" Legend	Legend 3/8" IP plug
17	129744	1	Bouchon chambre sèche satin Legend 2	Legend 2 satin dry chamber plug
18	129607	1	Bouchon ACD étrier	Yoke ACD Cap
19	129611	1	Rondelle chambre sèche Legend	Legend dry chamber washer
20	129609	1	Protecteur chambre sèche Legend	Legend dry chamber protector
21	129617	1	Sticker Legend encollé	Legend Sticker (with pasting)
22	129212	1	siège d'étrier Legend ACD	ACD Legend Yoke retainer
23	129204	1	Ressort ACD	ACD spring
24	129205	1	Siège Obturateur Etrier	Yoke Shutter Crown
25	129207	1	Nez Obturateur Etrier	Yoke Shutter Valve
26	124611	1	Etrier 98 poli	Bright 98 yoke
27	129618	1	Vis d'etrier Legend 2	Legend 2 Yoke screw
28	122244	1	Ressort	Spring
<b>29</b>	<b>124704</b>	<b>1</b>	<b>JT 1.9x7.2 EPDM 80ShA</b>	<b>OR 1.9x7.2 EPDM 80ShA</b>
<b>30</b>	<b>119129</b>	<b>1</b>	<b>Bague Anti Extrusion 1,35 x 3,56 NITRILE 90ShA</b>	<b>Anti Extrusion Washer 1,35 x 3,56 NITRILE 90ShA</b>
<b>31</b>	<b>124612</b>	<b>1</b>	<b>JT 1.78x2.9 EPDM 90ShA</b>	<b>OR 1.78x2.9 EPDM 90ShA</b>
<b>32</b>	<b>213714</b>	<b>1</b>	<b>JT 2x11 EPDM 80shA</b>	<b>OR 2x11 EPDM 80shA</b>
<b>33</b>	<b>124703</b>	<b>5</b>	<b>Bague</b>	<b>O-ring</b>
<b>34</b>	<b>473056</b>	<b>1</b>	<b>JT 1.78 x 5.28 EPDM 80ShA</b>	<b>O-ring 1.78 x 5.28 EPDM 80ShA</b>
<b>35</b>	<b>124701</b>	<b>2</b>	<b>Joint torique 1.78x8.74</b>	<b>O-ring 1.78x8.74</b>
36	129747	1	Echangeur chambre sèche satin LEGEND 2	LEGEND 2 satin dry chamber Ring
37	129746	1	Chambre compensation satin LEGEND 2	LEGEND 2 satin counter balance cylinder

(A)

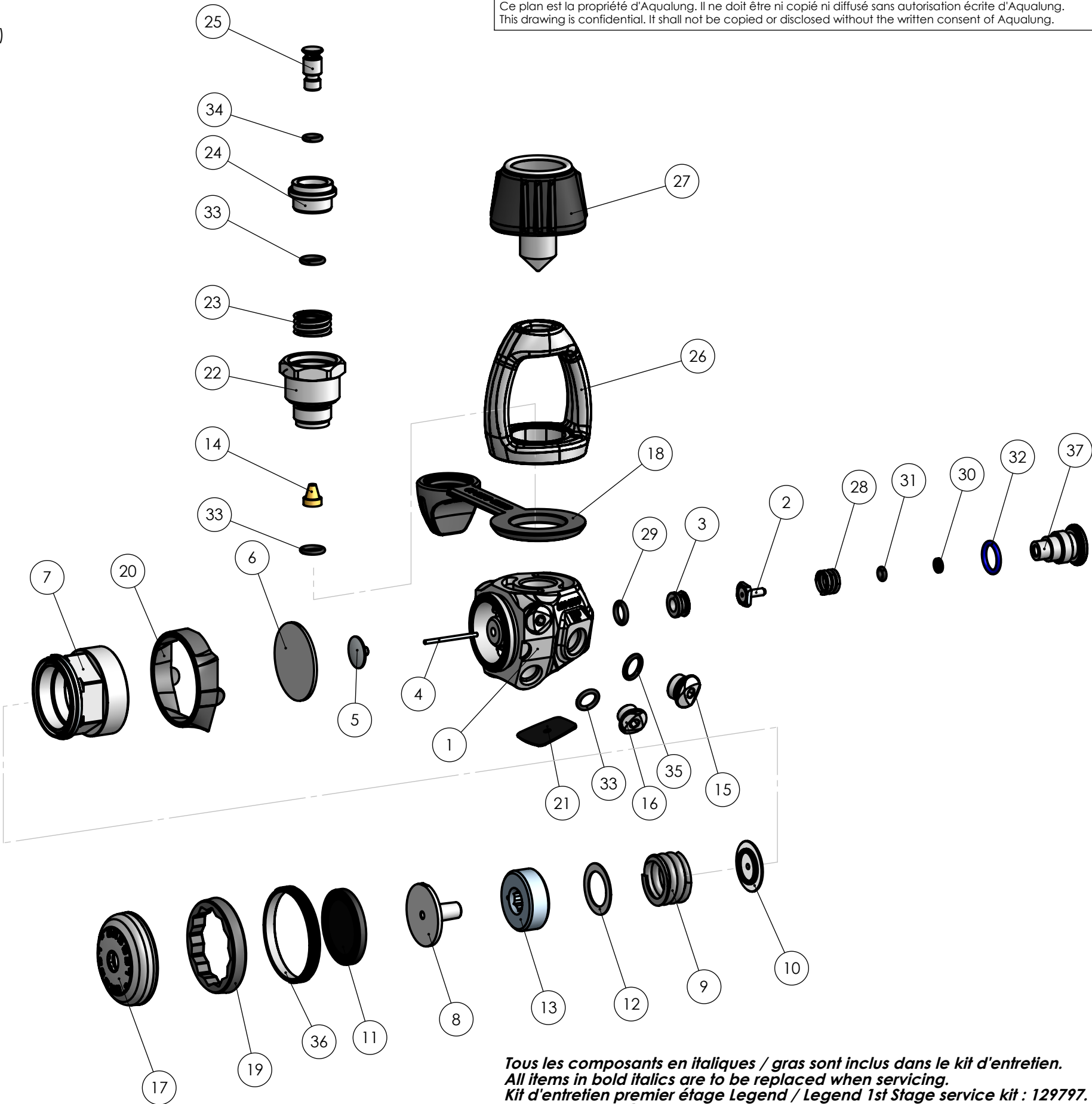

			Désignation	Premeir étage Legend 2 suprême ACD	Visa: TM
			Description	Legend 2 supreme ACD First Stage	1ère Avenue, 14ème rue - BP 148 06513 CARROS CEDEX FRANCE Tel: (33) 04 92 08 28 88 Fax: (33) 04 92 08 28 99
			Notice	-----	<b>AQUALUNG</b>
2063	08/12/11	A	Date	29/06/11	
N°	Date Modif	Ind			
					VE 129725 A