

CYLINDER'S FEATURES:

Working Pressure = 237 bar

Test Pressure = 363 bar

Water Capacity (nominal, l)	External Diameter (D) (nominal, mm)	Length (L) (nominal, mm)	Weight (nominal, kg)
15,3	184	745	17,8

According to DOT / TC EXEMPTION

Cylinder manufactured from plate

Chromium molybdenum steel

Notes:

- Neck threads according to customer's requirements

- Cylinder for HIGH PRESSURE GAS

- Reference Number: DTCUS78 -Rev.: 00 -Pos: A1

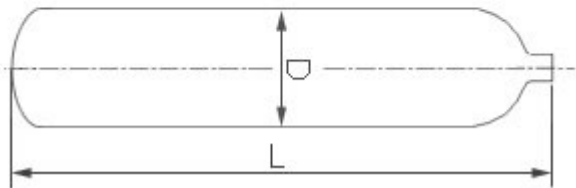
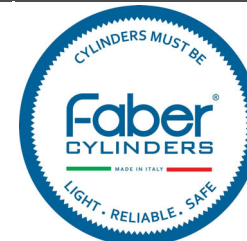

www.faber-italy.com

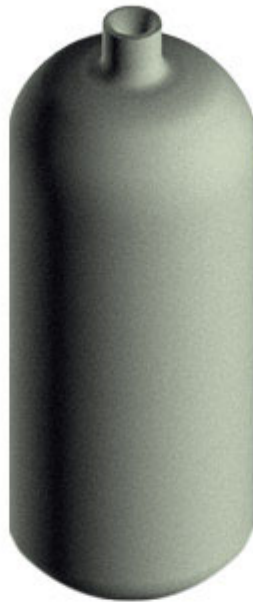

CYLINDER'S FEATURES:

Working Pressure = 237 bar

Test Pressure = 363 bar

Water Capacity (nominal, l)	External Diameter (D) (nominal, mm)	Length (L) (nominal, mm)	Weight (nominal, kg)
15,3	184	745	17,8

According to DOT EXEMPTION
Cylinder manufactured from plate
Chromium molybdenum steel

Notes:

- Neck threads according to customer's requirements

- Cylinder for HIGH PRESSURE GAS

- Reference Number: DUSA151 -Rev.: 00 -Pos: A1

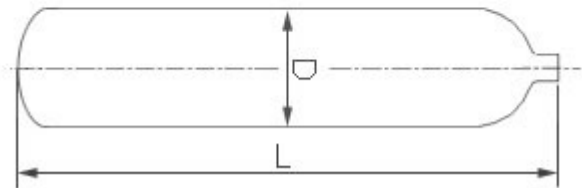

www.faber-italy.com