

Cousteau • SEA

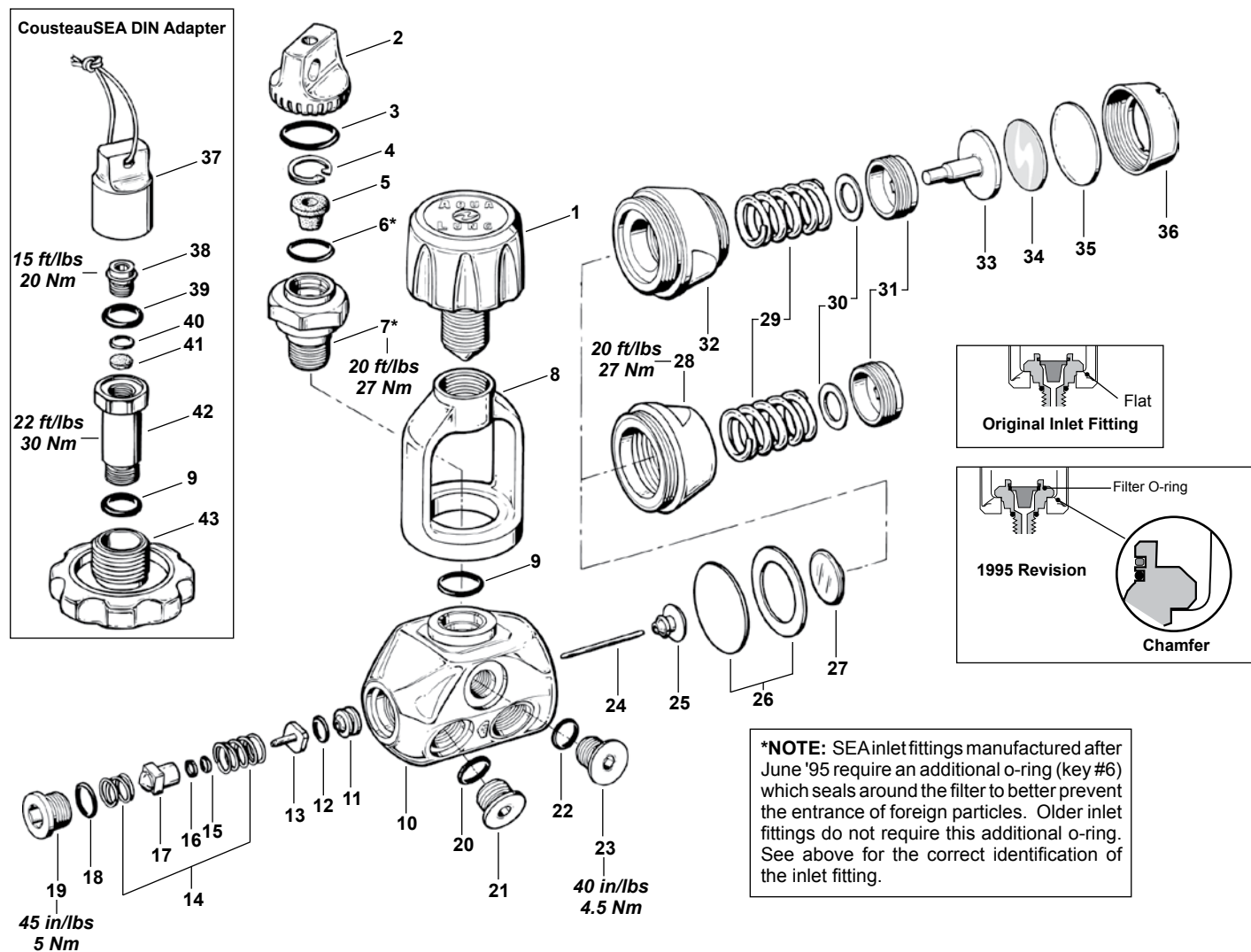

Key #	Part #	Description
-----	100511	First Stage, Cousteau, Yoke
-----	100521	First Stage, Cousteau Dry, Yoke
-----	900000	Overhaul Parts Kit
1 ----	107507	Yoke Screw
2 ----	103114	Dust Cap
3 ----	820094	O-ring
4 ----	863051	Circlip
5 ----	106839	Filter
6 ----	820014	O-ring
7 ----	106339	Inlet Fitting
8 ----	124611	Yoke
9 ----	820013	O-ring
10 ----	106322	Body
11 ----	106027	Crown
12 ----	820038	O-ring
13 ----	105940	HP Seat
14 ----	101509	Spring Kit (includes both springs)
15 ----	820080	O-ring
16 ----	119129	Backup Ring
17 ----	101565	Balance Chamber
18 ----	824407	O-ring
19 ----	106327	End Plug
20 ----	957004P	O-ring (25 pk)
21 ----	106303	Plug, HP Port, 7/16 inch
22 ----	820011P	O-ring (25 pk)
23 ----	106304	Plug, MP Port, 3/8 inch

Key #	Part #	Description
24 ----	106323	Pin
25 ----	106022	Pin Support
26 ----	103425	Diaphragm w/ Thrust Washer
27 ----	124560	Spring Pad
28 ----	106324	Spring Retainer
29 ----	106356	Spring
30 ----	845097	Washer
31 ----	106026	Adjustment Screw
Dry Environmental Chamber (Cousteau or SEA)		
-----	100525	Dry Environmental Kit, Complete
32 ----	106317	Spring Retainer, Dry
33 ----	106319	Piston
34 ----	106338	Decal
35 ----	106337	External Diaphragm
36 ----	106318	Diaphragm Retainer

Cousteau/SEA DIN Adapter

-----	106345	DIN Adapter Kit
37 ----	107441	Protector Cap, DIN Connector
38 ----	NLA	Filter Retainer
39 ----	820094	O-ring 124709
40 ----	820010P	O-ring (pre-1999 models only) (25 pk)
41 ----	106326	Filter
42 ----	106333	Inlet Fitting
43 ----	NLA	Handwheel

Part numbers in **BOLD ITALICS** indicate standard overhaul replacement part.