

Blue Steel Valve Schematic

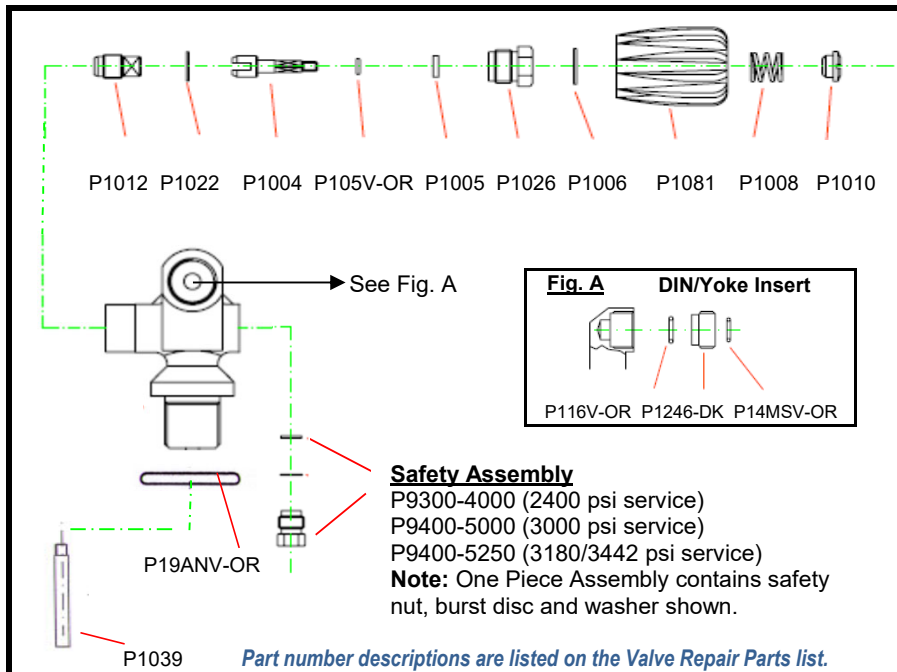

For Valve Models: 10081, 10082, 10107, 10108, 10111, 10112, 10120, 10113 (DIN Only - No Insert) and 18040 Inline Valve.

Torque Values:

Packing Nut	29-30 Ft Lbs. Maximum
Safety Assembly	11 Ft Lbs. Maximum
DIN/Yoke Insert	15 Ft Lbs. Maximum

Part #	Description
P1004	Stem
P1005	Packing
P1006	Handwheel Washer
P1008	Handwheel Spring
P1010	Handwheel Nut
P1012	Seat Assembly
P1022	Packing Nut Washer
P1026	Packing Nut Plated (Bonnet)
P2039	Dip Tube, Plated
P1035	Handwheel, Black, Short
P1037	Handwheel, Green, Short (Oxy.)
P1081	Handwheel, Black, Long
P1246-DK	DIN/K Outlet Adaptor
P1299	Black Bump Cap for Inline Valve
O-RINGS	
P105V-OR	Stem (Viton)
P19ANV-OR	Valve Inlet (Viton)
P116V-OR	Outlet Adaptor (Viton)
P14MSV-OR	K Outlet Face (Viton)
SAFETY ASSEMBLIES (Burst Disc)	
P9300-4000	4000 PSI for 2400 PSI
P9400-5000	5000 PSI for 3000 PSI
P9400-5250	5250 PSI for 3180/3442 PSI

Valve maintenance should only be performed by qualified personnel. NOTE: Only Oxygen-compatible lubricant should be used when replacing parts.

Only Blue Steel Scuba OEM parts should be used in repairing or refurbishing of Blue Steel Scuba valves. The use of other manufacturers valve parts in Blue Steel Scuba valves is not recommended and may result in failure of valve to operate properly and will void any warranty implied or offered.